

3.4. BUILT ENVIRONMENT AND HERITAGE

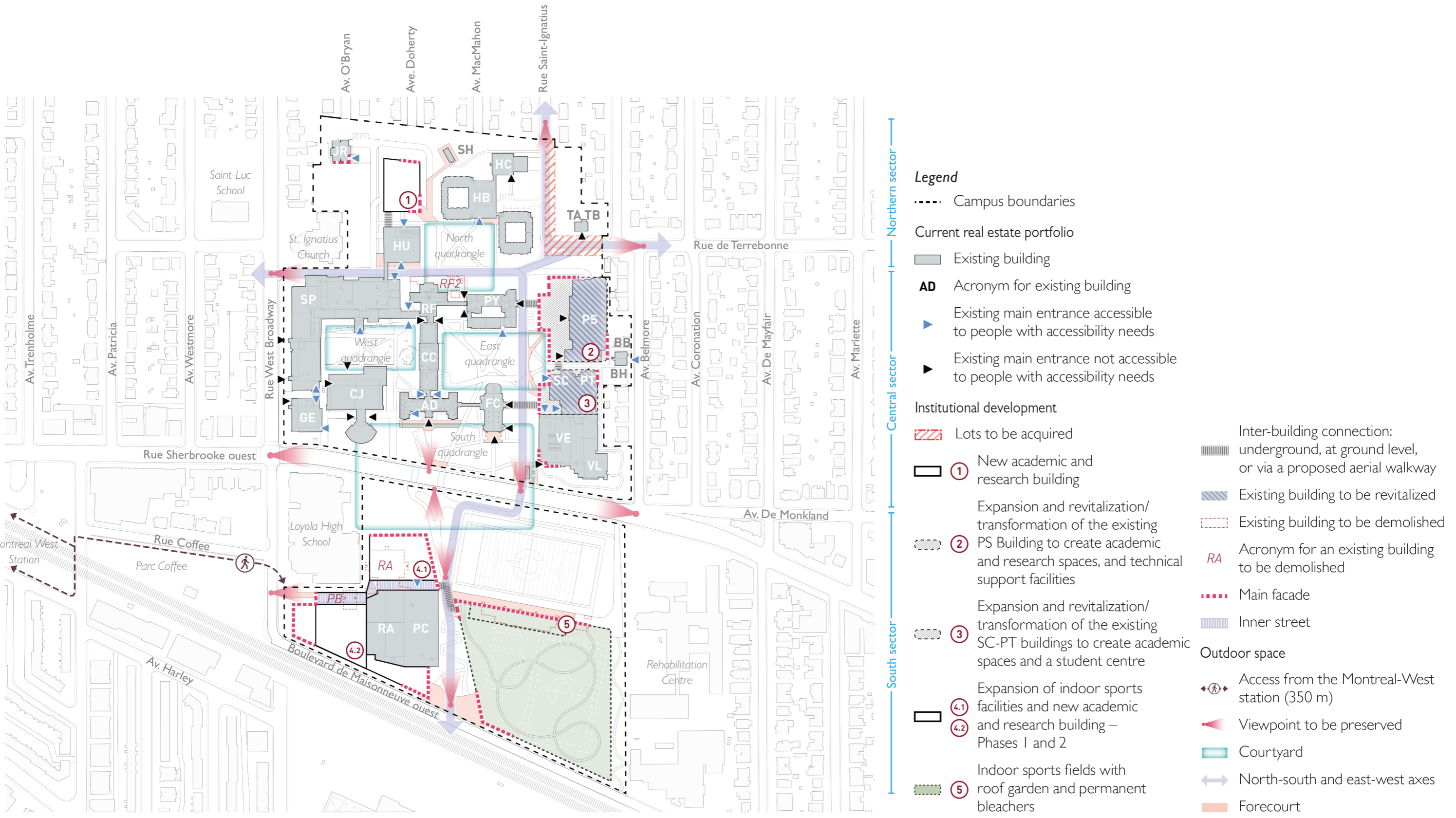

Location of the built environment and its relationship with the context

100 m

3.4. BUILT ENVIRONMENT AND HERITAGE

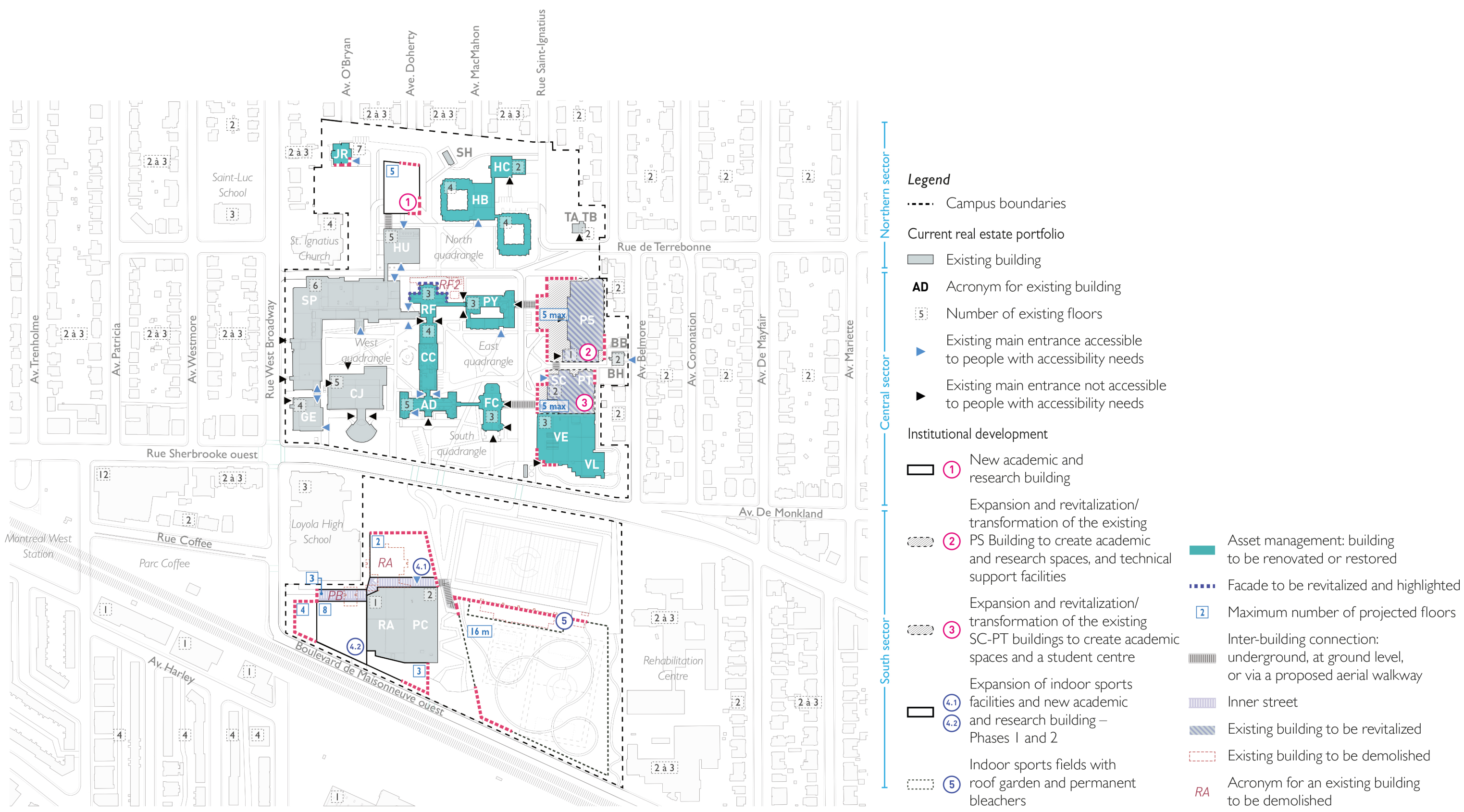

Legend

- Campus boundaries
- Current real estate portfolio**
- Existing building
- AD** Acronym for existing building
- Number of existing floors
- Existing main entrance accessible to people with accessibility needs
- Existing main entrance not accessible to people with accessibility needs
- Institutional development**
- 1 New academic and research building
- Expansion and revitalization/transformation of the existing PS Building to create academic and research spaces, and technical support facilities
- 2 PS Building to create academic and research spaces, and technical support facilities
- Expansion and revitalization/transformation of the existing SC-PT buildings to create academic spaces and a student centre
- 3 Expansion of indoor sports facilities and new academic and research building – Phases 1 and 2
- Indoor sports fields with roof garden and permanent bleachers
- Asset management: building to be renovated or restored
- Facade to be revitalized and highlighted
- 2 Maximum number of projected floors
- Inter-building connection: underground, at ground level, or via a proposed aerial walkway
- Inner street
- Existing building to be revitalized
- Existing building to be demolished
- RA Acronym for an existing building to be demolished

Placement of the built environment and its relationship with the context

